

# AUSTAL PATROL 40



YARD NO: 521 - 542  
GUARDIAN CLASS PATROL BOAT

DESTINATION: PACIFIC ISLAND NATIONS

EXPECTED DELIVERY: 2018-2023

CLIENT: COMMONWEALTH OF AUSTRALIA

## PRINCIPAL DIMENSIONS

Length overall	39.5 metres
Beam (overall)	8.0 metres
Draft, Loaded (approx.)	2.5 metres

## COMMUNICATION & SENSORS

Communication	VHF/DSC Radios, MF/HF DSC Radios, VHF Aeroband Radio, UHF Military Radio, Inmarsat C, SatCom, HF and VHF Radio Direction Finder
Navigation	X-Band Radar, Electronic Chart System, DGPS, Gyrocompass, Autopilot, Depth Sounder

## ACCOMMODATION

Berths	23
--------	----

## ARMAMENT

Space and weight reservation for a single foredeck mounted naval gun, port and starboard midship machine guns

## ADDITIONAL FEATURES

Ships Boat	1 x Work Ribs (WRH635FRB) SOLAS approved Fast rescue boat for 15 persons @ 100kg Powered by 2x90hp outboard motors
Cargo Deck	16m <sup>2</sup> with lashing grid serviced by crane

## PROPULSION

Main engines	2 x Caterpillar 3516C 2 x 2000 bkW @ 1600 rpm
Gearboxes	2 x ZF 7600 (with trolling valves)
Propellers	2 x fixed pitch

## PERFORMANCE

Speed (SS4)	20 knots at 100% MCR
Range at 12 knots (SS4)	3,000 nm

## CLASSIFICATION

Lloyd's Register  
✠100A1 SSC Patrol Mono HSC G6 MCH

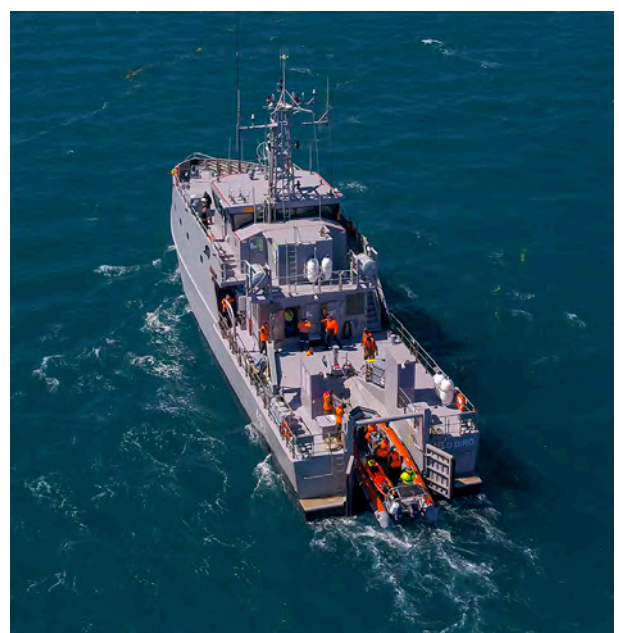

# AUSTAL PATROL 40

Vessel Type: Pacific Patrol Boat

PROFILE

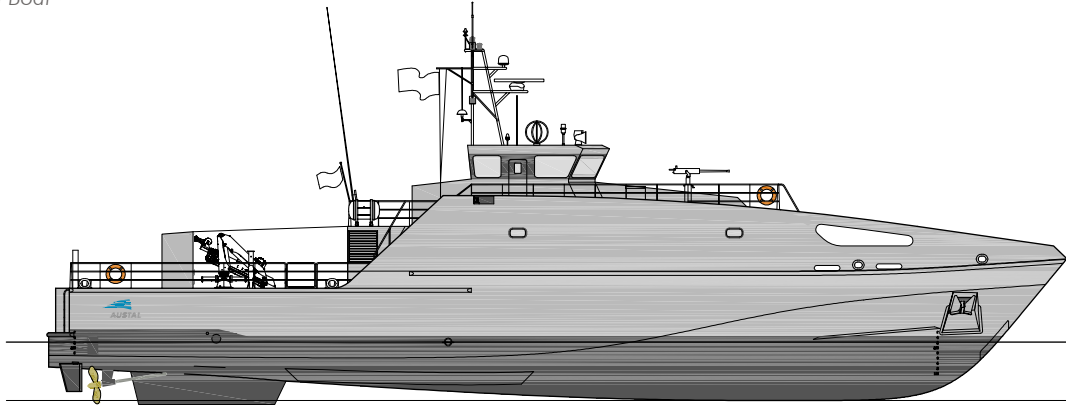

PROFILE @ CENTRELINE

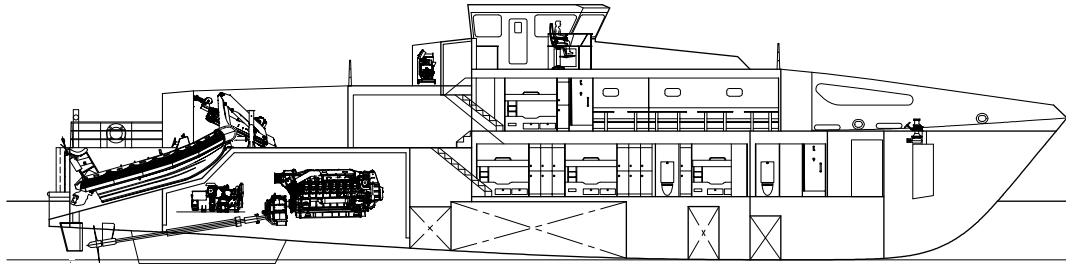

BRIDGE DECK

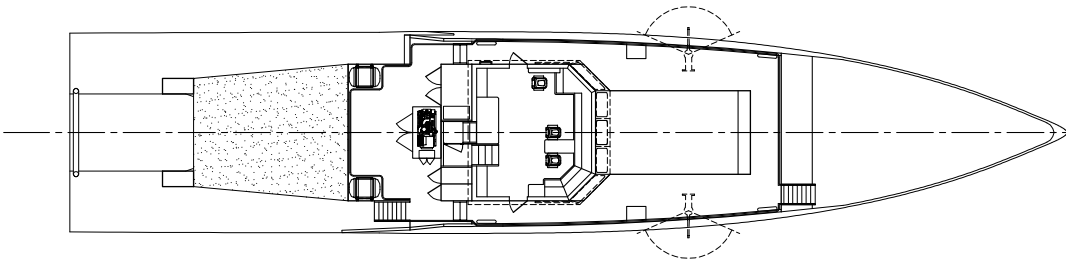

MAIN DECK

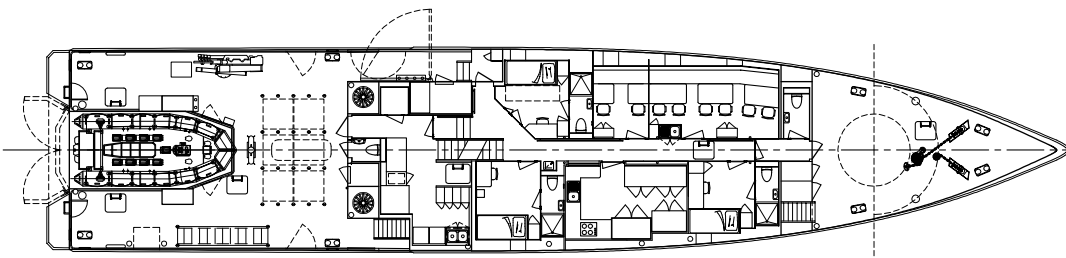

LOWER DECK

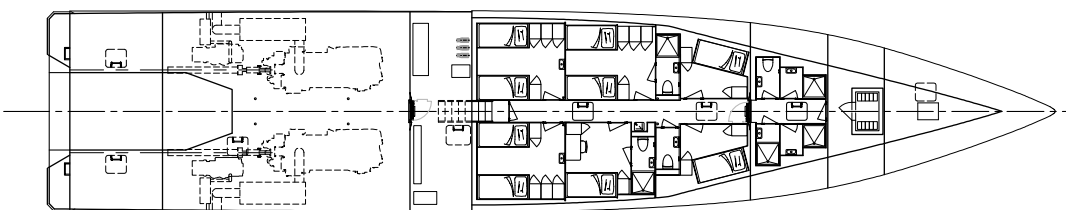

YARD NO: 521 - 541

DESTINATION: PACIFIC ISLAND NATIONS

EXPECTED DELIVERY: 2018-2023

CLIENT: COMMONWEALTH OF AUSTRALIA